

Flexyfoot Shock Absorbing Walking Stick Ferrules



Available in black or grey and four sizes:
16mm, 19mm, 22mm & 25mm,
to fit most walking aids

Flexyfoot Walking Sticks

All handle types are available in four colours



Cork Handle

Derby Handle

Oval Handle

Derby Handle

Cork Handle Telescopic Stick

Derby Handle Telescopic Stick

Oval Handle Telescopic Stick

Derby Handle Telescopic Stick

flexyfoot

Comfort Safety Style



● Improved Comfort ● Improved Safety ● Improved Style

Crutch Instructions

These crutches are designed to provide additional support to people who have difficulty walking but can partially weight bear.

Adjusting Crutch Height

1. First remove the e-clip from the lower section of the crutch (1).
2. Slide inner tube to adjust the crutch to the required height.
3. The handle should be in line with the user's wrist when they are standing upright with their arms relaxed by their sides.
4. Align the holes and re-insert the e-clip making sure that it is securely in place.

Arm Cuff Adjustment

1. Remove the e-clip from the top section of the crutch (2).
2. Adjust the cuff to a comfy position.
3. Align the holes and re-insert the e-clip making sure that it is securely in place.



Please read and retain these instructions. More information can be found at: www.flexyfoot.com

The Flexyfoot Foot and Wear Markers

If the foot becomes damaged or you have reached the wear markers on the bottom of the foot, you will need to replace the foot.

1. Pull sharply on the foot until you hear a 'pop'.
2. Unscrew the foot anticlockwise from the collar.
3. You should now have the foot and collar separated.
4. Push the stick into the ferrule to ensure the ferrule is still tight to the stick.
5. Once the ferrule is securely in place, screw the foot clockwise into the ferrule until it rotates freely.
6. Then push the foot until it clicks into place.

Wear
Marker

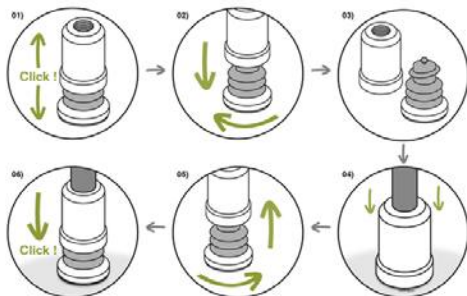
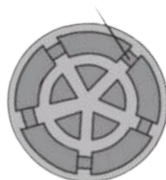

Maintenance and Caution

Check the condition of the foot and keep checking the wear markers. When you reach the wear markers, replace the foot.

If the fit of the collar becomes loose or can easily be removed, stop using the walking stick immediately.

Clean with soap and water. Do not use abrasive substances.

Level of grip will vary depending on such things as the weather and internal floor conditions. In wet conditions, as well as snow and ice, the grip will naturally be reduced.

Maximum user weight: 130Kg

Flexyfoot Products

The revolutionary and exclusive Flexyfoot Shock Absorbing ferrule can be fitted to almost any walking aid, but why not purchase a walking stick or crutch from our range, where this unique ferrule will be fitted as standard and every product comes with a wealth of additional benefits for your safety and comfort.

Accessories



Ice Boot

Flexyfoot Carbon
Fibre Crutches

Flexyfoot Shock Absorbing Crutch Ferrules



Black and grey are available in four sizes, 16mm, 19mm, 22mm & 25mm.

Folding Carbon Fibre Soft Grip



Flexyfoot Shock Absorbing Crutches

All styles are available in five colours

Folding Carbon Fibre Comfort Grip

